

AREA - CIRCLES

Here is another formula you have to memorize.

Area of a Circle

$$A = \pi \times r^2$$

Example:

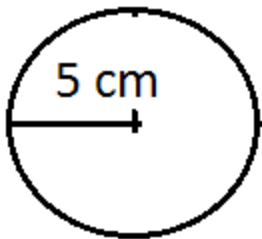

$$\text{Area} = \pi \times r^2$$

$$A = 3.14 \times 5^2$$

$$A = 3.14 \times 25 = 78.5 \text{ cm}^2$$

Note the difference you would get when you calculate circumference and area.

1. QUESTION

Find the area of the following circles.

a)

$$A = \pi \times r^2$$

Answer = _____

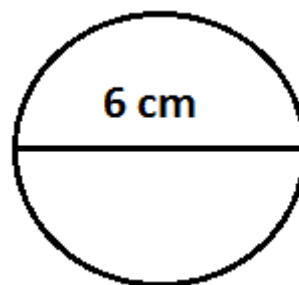

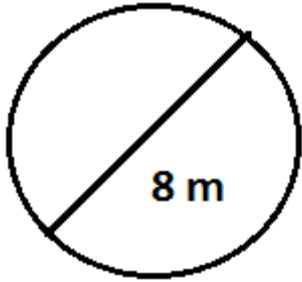

b)

$$A = \pi \times r^2$$

Answer = _____ m²

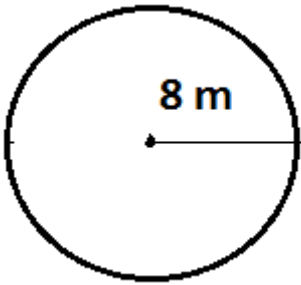

c)

$$A = \pi \times r^2$$

Answer = _____ m²

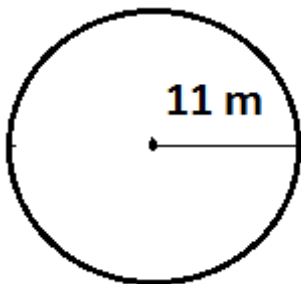

d)

Answer = _____ m²

e) A circle with a radius of 7 cm.

Answer = _____ cm²

2. QUESTION

What is the area of the following semi-circles?

a)

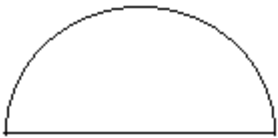

5.4 cm

Answer = _____ cm²

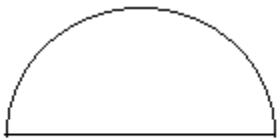

10 cm

b)

Answer = _____ cm²

c)

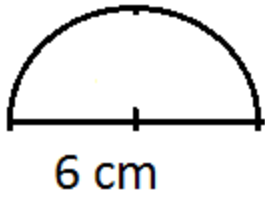

Answer = _____ cm²

3. QUESTION

Calculate the area of the shape below. (Guided practice)

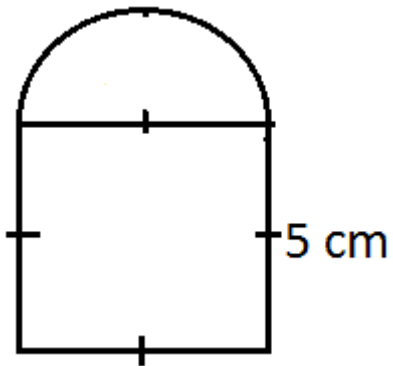

Answer = _____ cm²